

Legend

- Noise Monitoring Station
- Air Monitoring Station
- ▲ Real-time Noise Monitoring Station

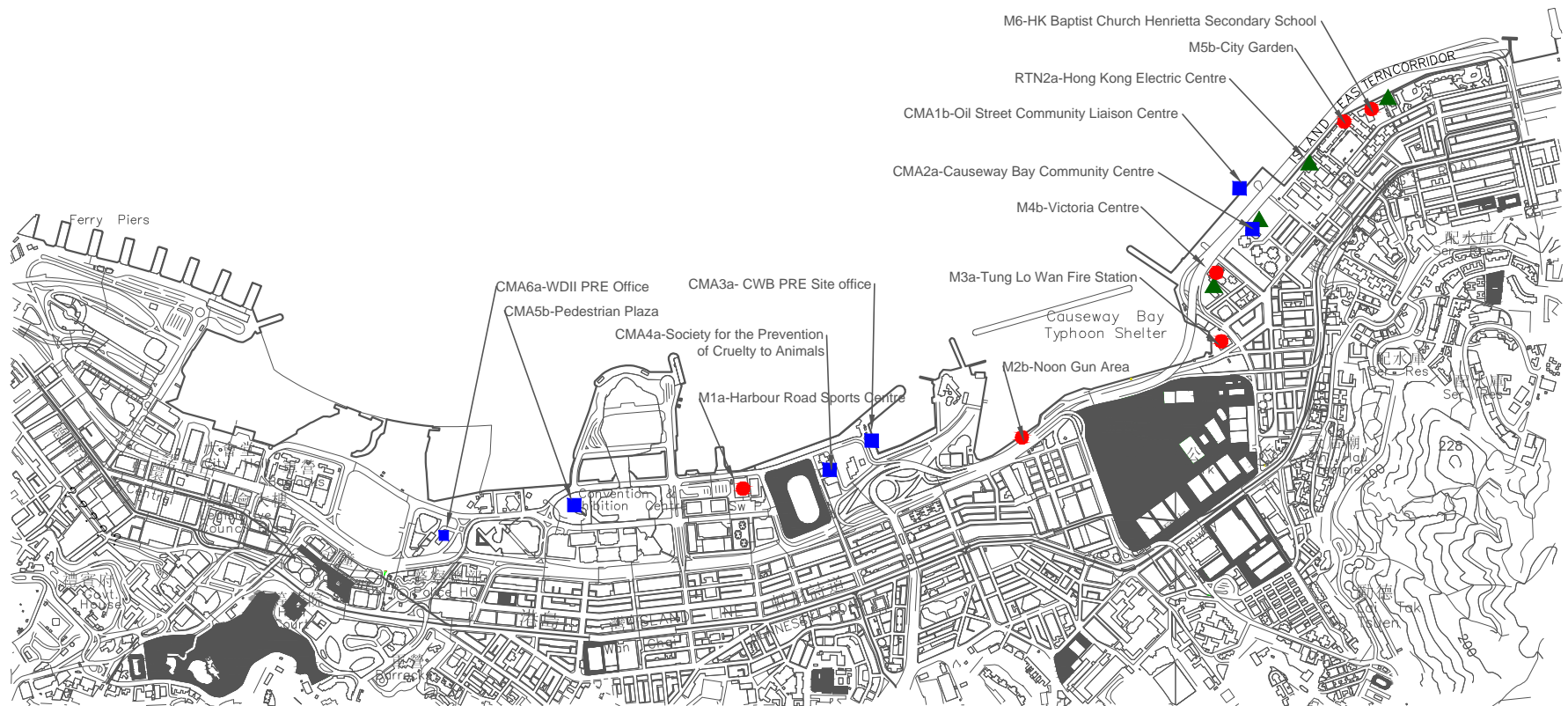

LOCATIONS OF AIR QUALITY AND NOISE MONITORING STATIONS

Legend

- ◆ Water Quality Monitoring Stations
- RW21-P789 (Wanchai WSD intake/ Great Eagle Centre/ China Resources Centre/ Sun Hung Kai Centre)
- C1 Hong Kong Convention and Exhibition Centre Extension
- P1 Hong Kong Convention and Exhibition Centre Phase 1
- P3 HK Academy For Performing Art
- P4 Shui On Centre
- P5 Government buildings (Wanchai Tower/ Revenue Tower/ Immigration Tower)
- C6 Proposed Exhibition Station/ World Trade Centre
- C7 Windsor House

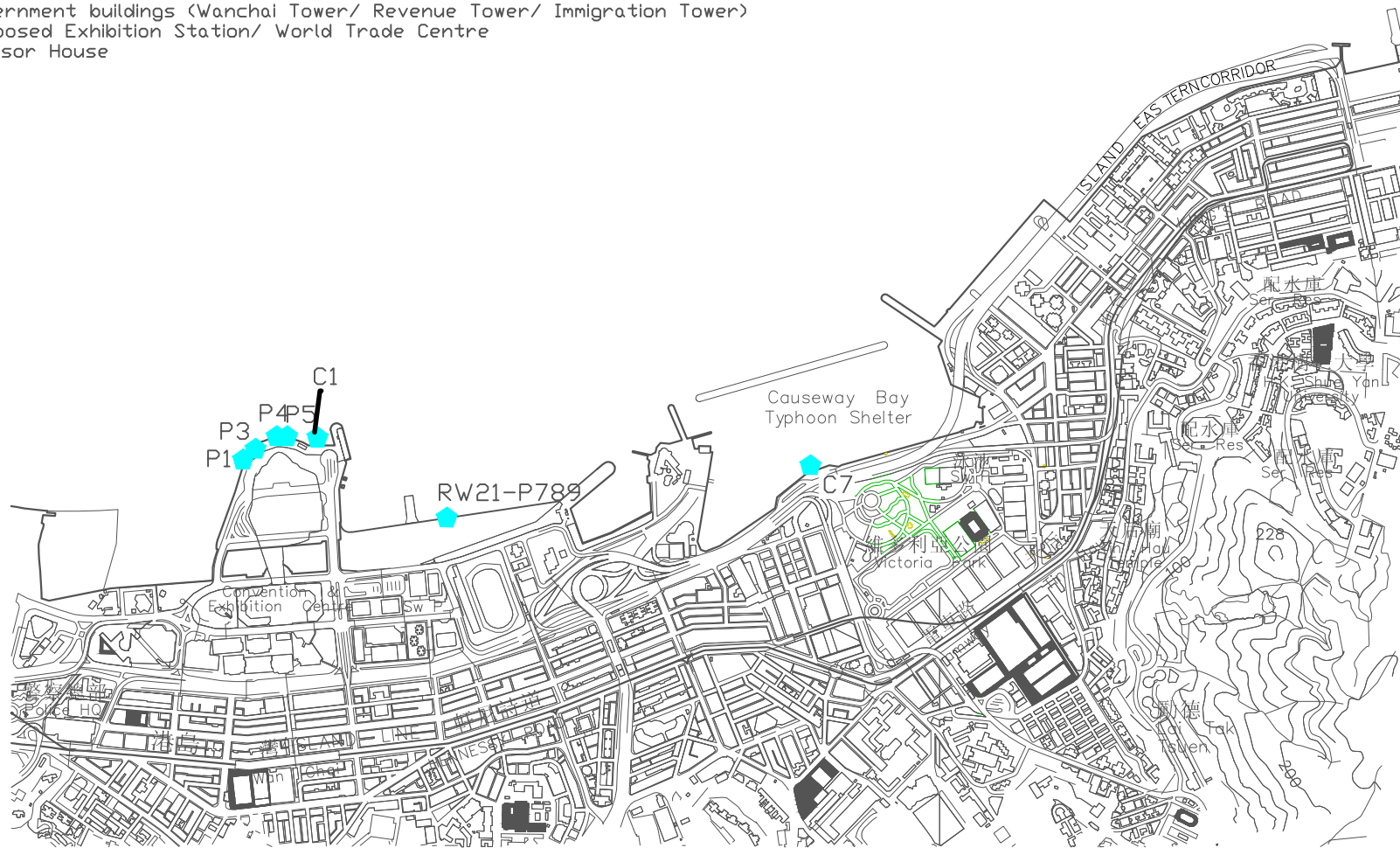

FIGURE

LOCATIONS OF WATER QUALITY MONITORING STATIONS

Legend

- ◆ Enhance DO Monitoring Stations
- Ex-PCWA SE Ex-Public Cargo Wanchai Area SouthEast Station
- Ex-PCWA SW Ex-Public Cargo Wanchai Area Southwest Station
- C6 Proposed Exhibition Station/ World Trade Centre
- C7 Windsor House

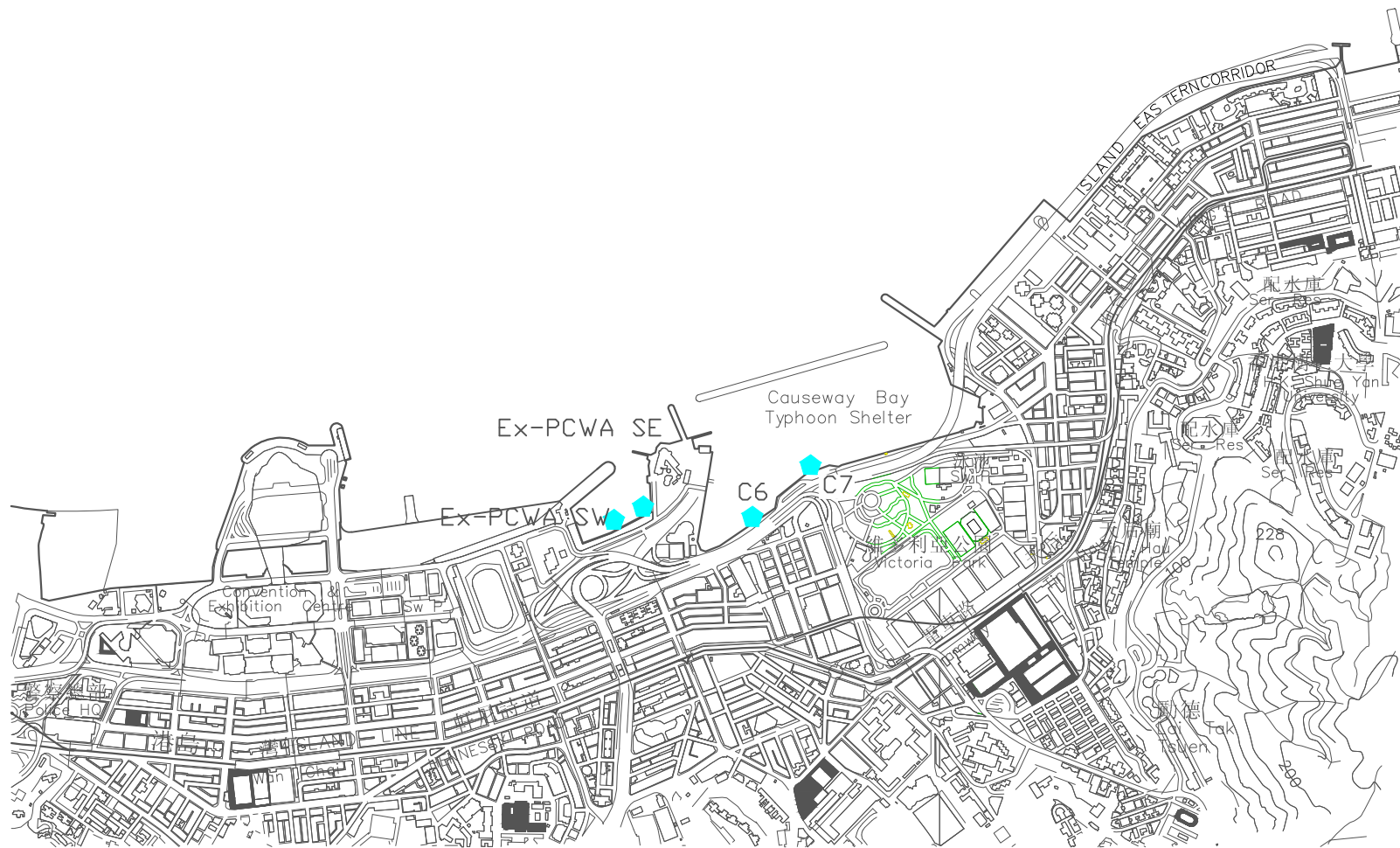

FIGURE

LOCATIONS OF ENHANCE DO MONITORING STATIONS

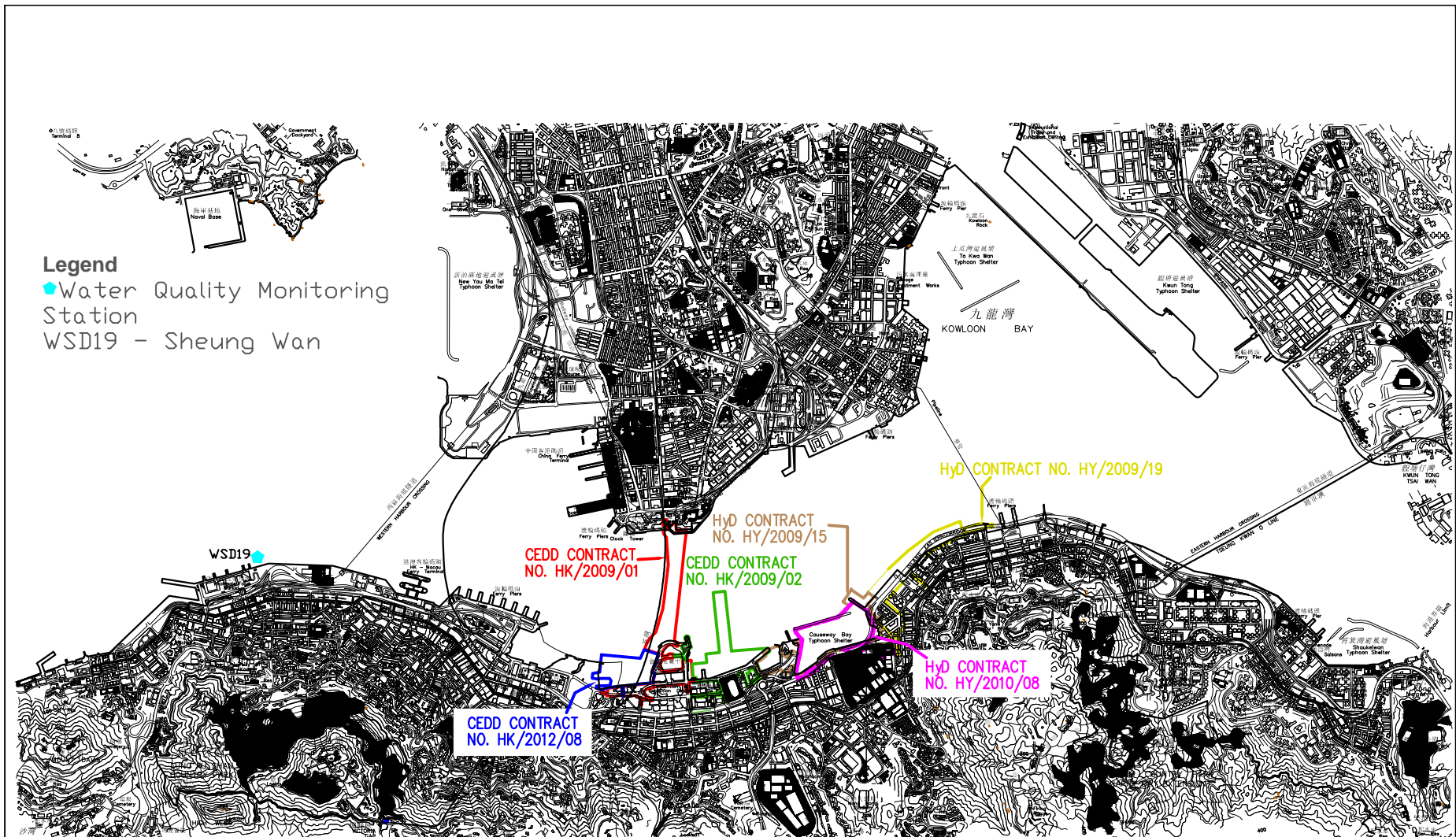

FIGURE

LOCATIONS OF WATER QUALITY MONITORING STATIONS

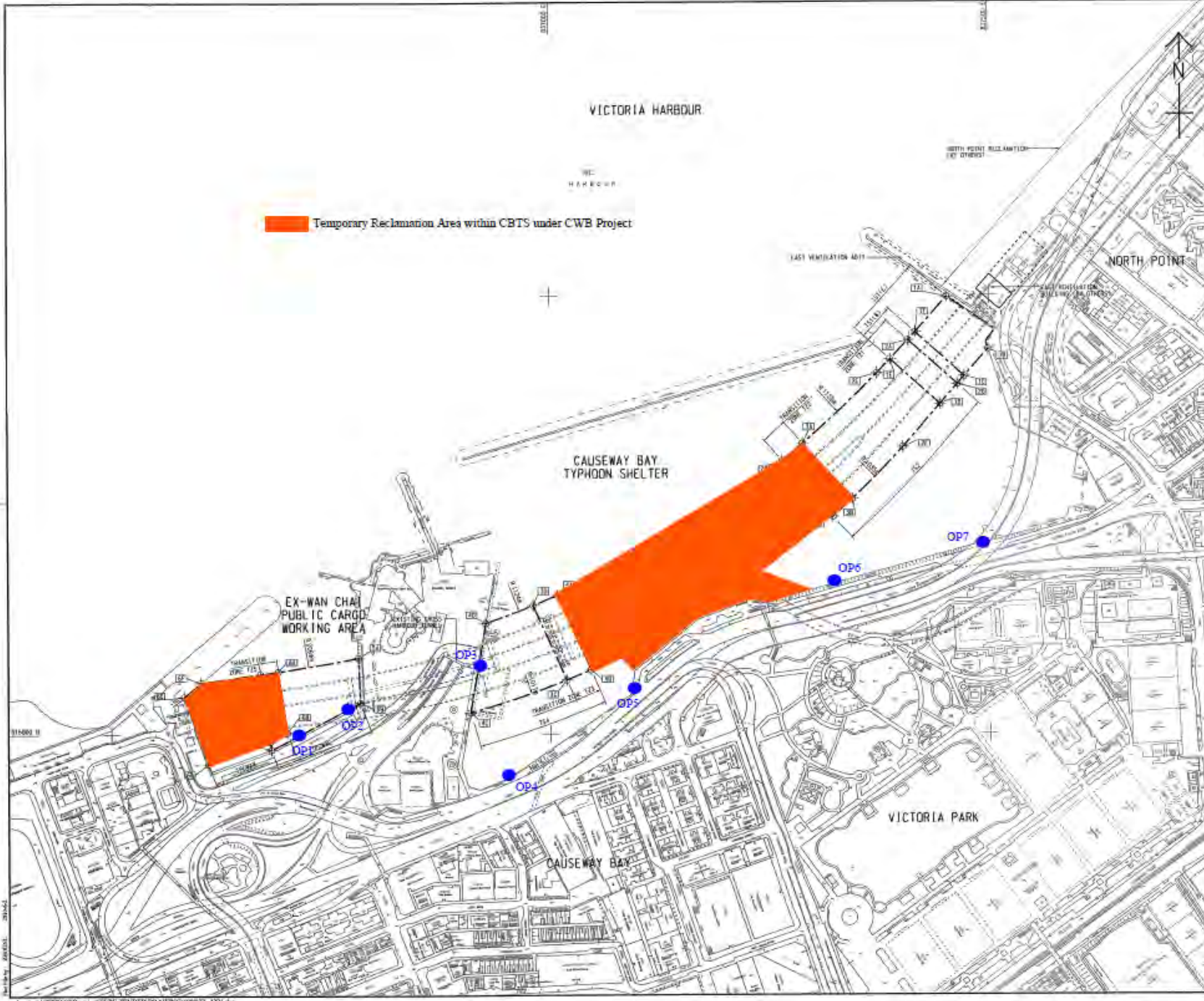

Temporary Reclamation Area within CBTS under CWB Project



KEY PLAN
SCALE AS 1 : 10000

Remarks:

1. With respect to the temporary reclamation undertaken within Ex-PCWAW area, the odour monitoring station OP1 is finely adjusted to temporary embayment area at the Enhance DO monitoring station to monitor for the potential odour nuisance in the area.
2. With respect to the temporary reclamation undertaken within CBTS, the odour monitoring station OP6 was finely adjusted to east of temporary reclamation zone for odour monitoring

DATE: 20/05/2014

10/10